

NARIMEX HVAC ROOFTOP SOLUTIONS FOR REVIT



Complete non-penetrating support systems for rooftop mechanical equipment. Our galvanized steel frame systems with recycled HDPE feet provide load-bearing, vibration-dampening support for chillers, air handling units, condensers, cable management, and pipework—engineered for flat roof installations without compromising waterproofing membranes. Optional galvanizing for profiles HD/PG according to ISO 1461.

Narimex HD Support Frame

Heavy duty flat roof support system featuring 41x41x2.5mm back-to-back channel configuration for increased load capacity. Provides superior strength. Suitable for M&E services, Air Conditioning & Refrigeration on flat roofs ensuring no roof membrane penetration. Anti-Vibration pads pre attached to feet.

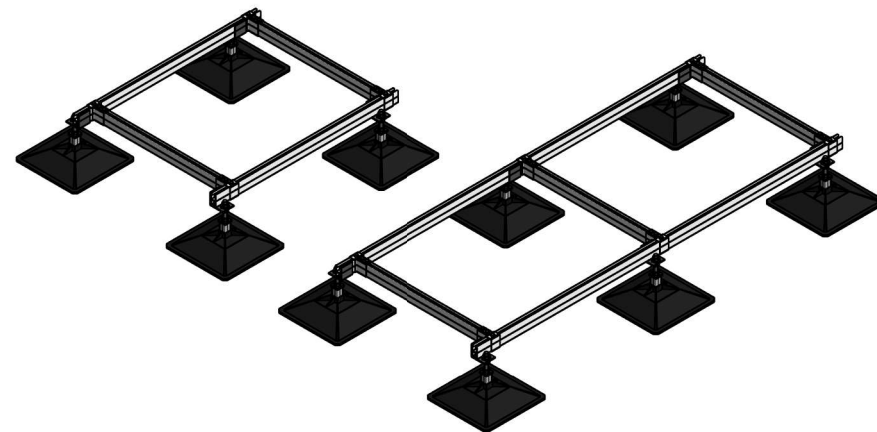

Narimex - H Frame (SFR)

H Frame system combining recycled SBR rubber feet with strut channel framework for enhanced vibration dampening. Ideal for supporting services requiring noise reduction with the durability of rubber construction.

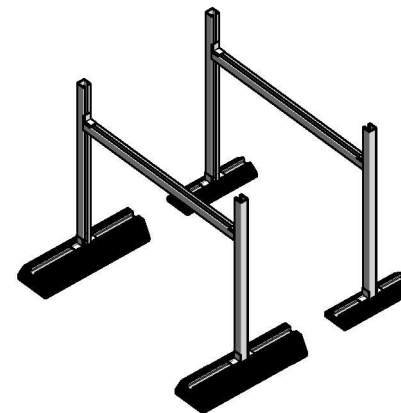

SFR Rubber Foot

Recycled SBR rubber foot with bonded 41x21mm aluminum channel, providing vibration absorption and UV stability for pipe work and cable tray support. Suitable for internal/external applications from -40°C to +80°C with loading capacity up to 645kg depending on model.

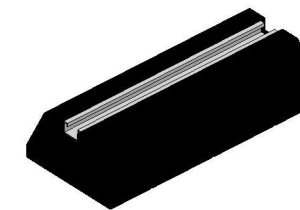

Narimex - H Frame (HDPE Foot)

Quick-install H Frame kit with 100% recycled HDPE plastic feet featuring pre-attached anti-vibration pads and no roof membrane penetration. Available in leg dimensions of 200mm (300kg SWL), 305mm (350kg SWL), and 500mm (500kg SWL) for cable management and ducting support.

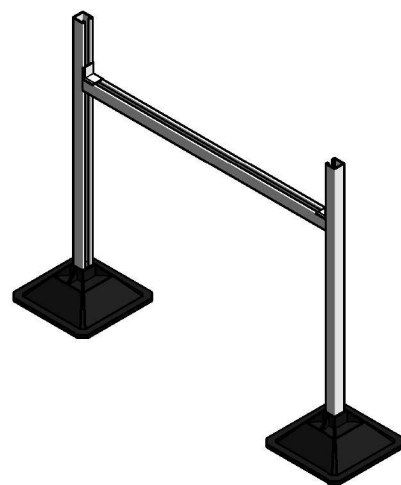

Narimex LD Support Frame

Lightweight duty flat roof support system using single 41x41x2.5mm slotted strut channel with adjustable HDPE. Fast & economical systems for mounting M&E services, Air Conditioning & Refrigeration on flat roofs ensuring no roof membrane penetration. Anti-Vibration pads pre attached to feet.

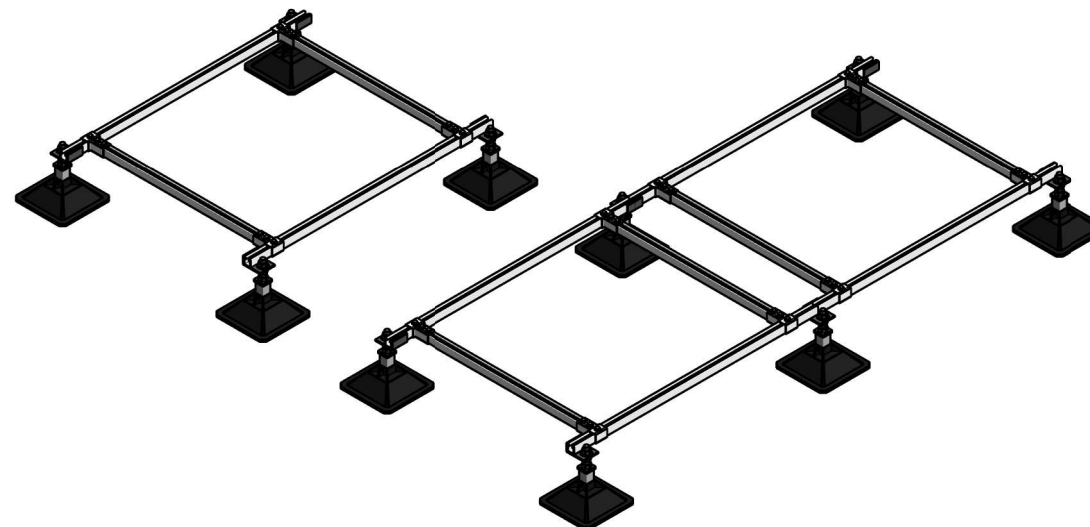

Narimex Super Duty Frame

Heavy-duty H Frame system with welded base plates/HDPE Foot. Structural Profiles 80x80mm or 100x100mm, designed for floor mounting or ceiling suspension applications.

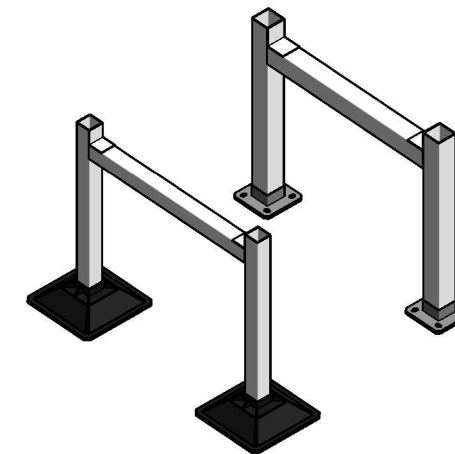

REVIT MODEL INSTRUCTIONS

Thank you for downloading the Narimex Revit products. Below are two simple ways to add Narimex families to your project.

Method 1: Transfer Project Standards (Recommended for multiple families)

1. Open your Revit project
2. Go to the Manage tab > Transfer Project Standards
3. Select the Narimex showcase file as the source
4. Choose the families you want to transfer
5. Click "OK" — all selected families are now in your project and ready to use

Method 2: Copy and Paste (For specific families)

1. Open the Narimex showcase file
2. In the Project Browser, go to Families > Narimex
3. Right-click the desired family (hold Shift to select multiple families)
4. Choose "Copy to Clipboard"
5. Switch to your project and paste with **Ctrl+V**
6. All copied families are now in your project and ready to use

Tip: Use Method 1 if you need multiple families at once. Use Method 2 if you only need a few specific families.